

CFFP Tapered Plastic Screw-In Plug for A12, A22 and A32K Couplers

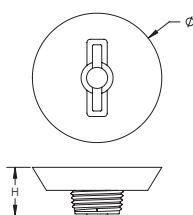

- Designed for use with the A12, A22 and A32K coupler families
- Designed to keep dirt, water and concrete slurry out of the coupler during the concrete pour
- Durable mounting plates allow for easy attachment to forms
- Color coded for the appropriate coupler size



Material: Polyethylene

Part Number	Article Number	Rebar Size, Metric	Rebar Size, US	Rebar Size, Canada	Diameter Ø	Height H	Color
EL12CFFP	156010	12 mm	#4	10M	59 mm	23 mm	Red
EL14CFFP	156020	14 mm	-	-	59 mm	23 mm	Green
EL16CFFP	156030	16 mm	#5	15M	59 mm	23 mm	Black
EL20CFFP	156050	20 mm	#6	20M	59 mm	23 mm	Yellow
EL25CFFP	156060	25 mm	#8	25M	59 mm	23 mm	Red
EL28CFFP	156070	28 mm	#9	30M	59 mm	23 mm	Black

EL12CFFP and EL16CFFP can also be used on the A2 coupler families.

WARNING

nVent products shall be installed and used only as indicated in nVent's product instruction sheets and training materials. Instruction sheets are available at www.erico.com and from your nVent customer service representative. Improper installation, misuse, misapplication or other failure to completely follow nVent's instructions and warnings may cause product malfunction, property damage, serious bodily injury and death and/or void your warranty.

© 2020 nVent All rights reserved

nVent, nVent CADDY, nVent ERICO, nVent ERIFLEX and nVent LENTON are owned by nVent or its global affiliates.

All other trademarks are the property of their respective owners. nVent reserves the right to change specifications without prior notice.