

A12 Standard Transition Coupler, Plain, Worldwide Design

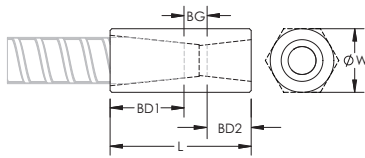

- Designed to splice different diameter bars where the second bar can be rotated and is not restricted in its axial direction
- Slim design maintains concrete cover
- Installs quickly and easily



Material: Steel

Finish: Plain

Design Version: Worldwide (Globally Available Materials)

Part Number	Rebar Size, Metric (mm)	Rebar Size, US	Rebar Size, Canada (M)	W (mm)	Ø (mm)	L (mm)	BD1 (mm)	BD2 (mm)	BG (mm)	Unit Weight (kg)	Certifications
EL1210A12N	12, 10	#4, #3	-	17	-	55	19	18	18	0.08	ITB
EL1410A12N	14, 10	-	-	22	-	57	21	18	18	0.15	ITB
EL1412A12N	14, 12	-	-	22	-	57	21	19	17	0.14	ITB
EL1610A12N	16, 10	#5, #3	-	22	-	61	24	18	19	0.15	ITB
EL1612A12N	16, 12	#5, #4	15, 10	22	-	61	24	19	18	0.14	ITB
EL1614A12N	16, 14	-	-	22	-	64	24	21	19	0.14	ITB
EL1810A12N	18, 10	-	-	27	-	66	29	18	19	0.25	ITB
EL1812A12N	18, 12	-	-	27	-	66	29	19	18	0.25	ITB
EL1814A12N	18, 14	-	-	27	-	69	29	21	19	0.25	ITB
EL1816A12N	18, 16	-	-	27	-	71	29	24	18	0.25	ITB
EL2010A12N	20, 10	#6, #3	-	27	-	74	35	18	21	0.27	ITB
EL2012A12N	20, 12	#6, #4	20, 10	27	-	74	35	19	20	0.26	ITB
EL2014A12N	20, 14	-	-	27	-	77	35	21	21	0.27	ITB
EL2016A12N	20, 16	#6, #5	20, 15	27	-	80	35	24	21	0.27	ITB
EL2018A12N	20, 18	-	-	27	-	85	35	29	21	0.27	ITB
EL2210A12N	22, 10	#7, #3	-	30	-	77	37	18	22	0.35	ITB
EL2212A12N	22, 12	#7, #4	-	30	-	77	37	19	21	0.34	ITB
EL2214A12N	22, 14	-	-	30	-	80	37	21	22	0.35	ITB
EL2216A12N	22, 16	#7, #5	-	30	-	83	37	24	22	0.35	ITB
EL2218A12N	22, 18	-	-	30	-	87	37	29	21	0.36	ITB
EL2220A12N	22, 20	#7, #6	-	30	-	95	37	35	23	0.38	ITB
EL2510A12N	25, 10	#8, #3	-	-	35	81	40	18	23	0.44	-
EL2512A12N	25, 12	#8, #4	25, 10	-	35	81	40	19	22	0.43	ITB

Part Number	Rebar Size, Metric (mm)	Rebar Size, US	Rebar Size, Canada (M)	W (mm)	Ø (mm)	L (mm)	BD1 (mm)	BD2 (mm)	BG (mm)	Unit Weight (kg)	Certifications
EL2514A12N	25, 14	-	-	-	35	83	40	21	22	0.44	ITB
EL2516A12N	25, 16	#8, #5	25, 15	-	35	86	40	24	22	0.45	ITB
EL2518A12N	25, 18	-	-	-	35	90	40	29	21	0.47	ITB
EL2520A12N	25, 20	#8, #6	25, 20	-	35	98	40	35	23	0.50	ITB
EL2522A12N	25, 22	#8, #7	-	-	35	100	40	37	23	0.49	ITB
EL2814A12N	28, 14	-	-	-	40	86	42	21	23	0.61	ITB
EL2816A12N	28, 16	#9, #5	30, 15	-	40	88	42	24	22	0.62	ITB
EL2818A12N	28, 18	-	-	-	40	93	42	29	22	0.65	ITB
EL2820A12N	28, 20	#9, #6	30, 20	-	40	101	42	35	24	0.69	ITB
EL2822A12N	28, 22	#9, #7	-	-	40	103	42	37	24	0.69	ITB
EL2825A12N	28, 25	#9, #8	30, 25	-	40	104	42	40	22	0.67	ITB
EL3016A12N	30, 16	-	-	-	40	99	52	24	23	0.66	-
EL3018A12N	30, 18	-	-	-	40	103	52	29	22	0.69	-
EL3020A12N	30, 20	-	-	-	40	110	52	35	23	0.73	-
EL3022A12N	30, 22	-	-	-	40	113	52	37	24	0.73	-
EL3025A12N	30, 25	-	-	-	40	115	52	40	23	0.71	-
EL3028A12N	30, 28	-	-	-	40	117	52	42	23	0.68	-
EL3216A12N	32, 16	#10, #5	-	-	45	92	45	24	23	0.81	ITB
EL3218A12N	32, 18	-	-	-	45	98	45	29	24	0.86	ITB
EL3220A12N	32, 20	#10, #6	-	-	45	105	45	35	25	0.92	ITB
EL3222A12N	32, 22	#10, #7	-	-	45	107	45	37	25	0.93	ITB
EL3225A12N	32, 25	#10, #8	-	-	45	109	45	40	24	0.91	ITB
EL3228A12N	32, 28	#10, #9	-	-	45	110	45	42	23	0.88	ITB
EL3230A12N	32, 30	-	-	-	45	120	45	52	23	0.95	-
EL3420A12N	34, 20	-	-	-	50	115	55	35	25	1.31	-
EL3422A12N	34, 22	-	-	-	50	117	55	37	25	1.32	-
EL3425A12N	34, 25	-	-	-	50	119	55	40	24	1.31	-
EL3428A12N	34, 28	-	-	-	50	120	55	42	23	1.28	-
EL3430A12N	34, 30	-	-	-	50	131	55	52	24	1.37	-
EL3432A12N	34, 32	-	-	-	50	123	55	45	23	1.24	-
EL3620A12N	36, 20	#11, #6	35, 20	-	50	112	52	35	25	1.22	-
EL3622A12N	36, 22	#11, #7	-	-	50	114	52	37	25	1.22	-
EL3625A12N	36, 25	#11, #8	35, 25	-	50	116	52	40	24	1.22	-
EL3628A12N	36, 28	#11, #9	35, 30	-	50	118	52	42	24	1.19	-
EL3630A12N	36, 30	-	-	-	50	128	52	52	24	1.28	-
EL3632A12N	36, 32	#11, #10	-	-	50	120	52	45	23	1.15	-
EL3634A12N	36, 34	-	-	-	50	130	52	55	23	1.23	-
EL3825A12N	38, 25	#12, #8	-	-	55	118	53	40	25	1.56	-
EL3828A12N	38, 28	#12, #9	-	-	55	119	53	42	24	1.54	-
EL3830A12N	38, 30	-	-	-	55	130	53	52	25	1.67	-
EL3832A12N	38, 32	-	-	-	55	122	53	45	24	1.51	-
EL3834A12N	38, 34	-	-	-	55	132	53	55	24	1.62	-
EL3836A12N	38, 36	#12, #11	-	-	55	128	53	52	23	1.51	-
EL4025A12N	40, 25	-	-	-	55	122	57	40	25	1.56	ITB
EL4028A12N	40, 28	-	-	-	55	123	57	42	24	1.54	ITB
EL4030A12N	40, 30	-	-	-	55	134	57	52	25	1.66	-
EL4032A12N	40, 32	-	-	-	55	126	57	45	24	1.50	ITB
EL4034A12N	40, 34	-	-	-	55	136	57	55	24	1.61	-

Part Number	Rebar Size, Metric (mm)	Rebar Size, US	Rebar Size, Canada (M)	W (mm)	Ø (mm)	L (mm)	BD1 (mm)	BD2 (mm)	BG (mm)	Unit Weight (kg)	Certifications
EL4036A12N	40, 36	-	-	-	55	132	57	52	23	1.50	-
EL4038A12N	40, 38	-	-	-	55	133	57	53	23	1.47	-
EL43T36A12N	43, 36	#14, #11	45, 35	-	60	148	66	52	30	2.10	-
EL50T32A12N	50, 32	-	-	-	70	147	70	45	32	3.00	-
EL50T34A12N	50, 34	-	-	-	70	156	70	55	31	3.22	-
EL50T36A12N	50, 36	-	-	-	70	153	70	52	31	3.08	-
EL50T38A12N	50, 38	-	-	-	70	154	70	53	31	3.06	-
EL50T40A12N	50, 40	-	-	-	70	157	70	57	30	3.09	-
EL57T43TA12N	57, 43	#18, #14	55, 45	-	80	184	83	66	35	4.87	-

Designed to Meet

AASHTO, ABNT NBR 8548:1984, ACI 318 Type 1 (125% Specified Yield), ACI 318 Type 2 (Specified Tensile), ACI 349, ACI 359, AS3600, BS EN 1992-1-1, BS EN 1992-2, CAN/CSA - N287.2/.3/.4, DIN EN 1992-1-1, Eurocode 2, IBC Type 1 (125% Specified Yield), IBC Type 2 (Specified Tensile), ISO 15835, NEN EN 1992-1-1, NF A 35-020-1, NF EN 1992-1-1, ÖNORM EN 1992-1-1, Sellafield Ltd. Std. ES_0_3110, US Army Corps of Engineers

Bar dimensions and weights listed may vary by region. Coupler sizes not shown may be available by special order. Contact your nVent LENTON representative for more information.

WARNING

nVent products shall be installed and used only as indicated in nVent's product instruction sheets and training materials. Instruction sheets are available at www.erico.com and from your nVent customer service representative. Improper installation, misuse, misapplication or other failure to completely follow nVent's instructions and warnings may cause product malfunction, property damage, serious bodily injury and death and/or void your warranty.

© 2020 nVent All rights reserved

nVent, nVent CADDY, nVent ERICO, nVent ERIFLEX and nVent LENTON are owned by nVent or its global affiliates.

All other trademarks are the property of their respective owners. nVent reserves the right to change specifications without prior notice.