

Bolt Cutters

8340 / 8340 Z BOLT CUTTERS



- > Compact power bolt cutters with effective cutting performance.
- > Optimum lever action requires less effort.
- > Wear-free rotating/thrust block bolt to reduce sliding friction when cutting.

- > The effective force multiplication ratio of 1:30 near the cutting edge.
- > Force optimised, cutting near joint is guaranteed.

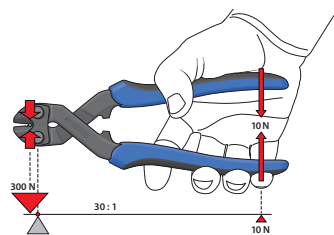

8340

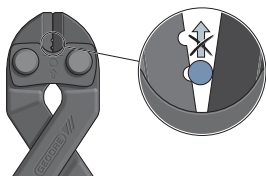

- > From soft to hard wires up to 4mmØ.
- > The grooves in the blades prevent sliding while cutting.

8340 Z

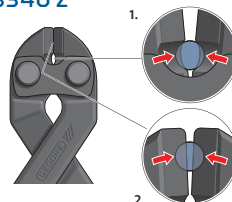

- > With a two-cut process, from soft to hard wires 4 to 6mmØ.
- > The extra cutting edge (1) serves as a first cut for thick bolts and engraves them.
- > In the second step, the main cutting edge (2) cuts through the bolt completely.

8340 MINI BOLT CUTTERS

- > The positioning of the blades close to the joint creates a particularly effective power to cutting ratio.
- > Blades additionally induction hardened (63-65HRC).
- > Precision cutting edges for soft wire up to 6.0mmØ, hard and piano wire up to 3.8mmØ.
- > Model JL = steel-grey, with blue dipped handle protectors.

8340 Z MINI BOLT CUTTERS

- > Optimum lever action requires less effort.
- > Cutting edges additionally inductively hardened (63 - 65HRC).
- > Double-sided milling near the joint ensures best leverage for thicker wire diameters.
- > Precision blades that can cut soft wire up to 6.0mmØ, hard wire up to 5,5mmØ and piano wire up to 3,8mmØ.
- > Model JL = steel-grey, with blue dipped handle protectors.



8340-200 JL



8340 Z-200 JL

Code	No.	l- mm -l	kg
2541300	8340 - 200JL	200	0.389

Code	No.	l- mm -l	kg
2666324	8340Z - 200JL	200	0.389

8178 BOLT CUTTERS

- > According to DIN ISO 5743.
- > Double cam bolt adjustment.
- > Cutting head replaceable.
- > Cutters from Chrome Vanadium steel.
- > Maximum cutting performance 48HRC.



Code	No.	max. ● mm	l- inch -l	l- mm -l	kg
2675137	8178 - 460	5	18	460	1.680
2675145	8178 - 620	7	24	620	2.460
2675153	8178 - 780	8	30	780	4.700
2675161	8178 - 900	9	36	900	5.000

Code	No.
2675196	E 8178 460 Replacement Cutting Head
2675218	E 8178 620 Replacement Cutting Head
2675226	E 8178 780 Replacement Cutting Head
2675234	E 8178 900 Replacement Cutting Head