

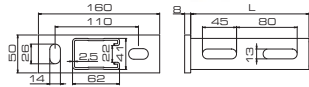

OG-SS-MH2,5



Length L [mm]	Weight [kg]	Designation for the order	Catalogue number
480	2,060	OG-SS-MH2,5-480	80941624801
1040	3,720	OG-SS-MH2,5-1040	80941620001



Permissible load

OG-SSD-MF2,5



Length L [mm]	Weight [kg]	Designation for the order	Catalogue number
480	2,160	OG-SSD-MF2,5-480	80941824801
1040	3,950	OG-SSD-MF2,5-1040	80941820001

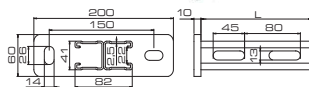

Permissible load

OG-SSD-MH2,5



Length L [mm]	Weight [kg]	Designation for the order	Catalogue number
480	4,330	OG-SSD-MH2,5-480	80941244801
1040	8,140	OG-SSD-MH2,5-1040	80941240001

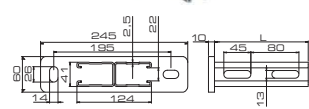

Permissible load

CHANNEL SUPPORTS OG-ST

hot-dip galvanized

**Usage:** connection of channels with the base material; allows independent creation of channels with feet and construction of fastening systems.



OG-ST-S

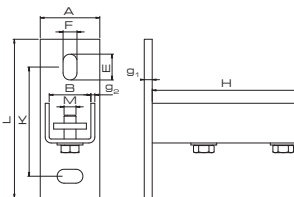

- The set includes:**
- u-profile welded on wall plate,
  - a threaded plate,
  - two round washers,
  - two bolts with hexagonal heads, full thread.

Permissible load

For channels	Dimensions								Weight [kg]	Quantity [pcs/pkg]	Designation for the order	Catalogue number
	A x L x g <sub>1</sub> [mm]	K [mm]	F x E [mm]	B [mm]	g <sub>2</sub> [mm]	H [mm]	M [mm]					
A, C	45x112x6	70	11x24	31	3	100	M10	0,413	5	OG-ST-SA	81125030301	
MF, MH, MI	60x160x8	110	14x26	42	4	150	M12	1,190	5/10	OG-ST-SMF	81120041411	

HOT-DIP GALVANIZED ELEMENTS

OG-SS  
OG-SSD  
CHANNEL SUPPORTS OG-ST



## VERTICAL CHANNEL SUPPORT OG-ST-S90

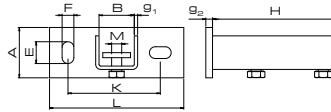

### The set includes:

- U-profile welded on a wall plate,
- a threaded plate,
- two round washers,
- two bolts with hexagonal head

Permissible load

For channels	Dimensions							Weight [kg]	Quantity [pcs/pkg]	Designation for the order	Catalogue number
	A x L x g <sub>1</sub> [mm]	K [mm]	F x E [mm]	B [mm]	g <sub>2</sub> [mm]	H [mm]	M [mm]				
MF, MH, MI	60x160x8	110	14x26	42	4	150	M12	1,190	5	OG-ST-SMF90	81160041411

## DOUBLED CHANNEL SUPPORT OG-ST-SD

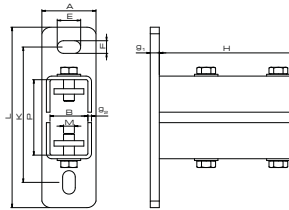

### Set includes:

- U-profile welded on a wall plate,
- two threaded plate,
- four round washers,
- four bolts with hexagonal heads, full thread head

Permissible load

For channels	Dimensions							Weight [kg]	Quantity [pcs/pkg]	Designation for the order	Catalogue number
	A x L x g <sub>1</sub> [mm]	K [mm]	F x E [mm]	B [mm]	g <sub>2</sub> [mm]	H [mm]	M [mm]				
D-MF	60x200x10	150	14X26	42x83,6	4	150	M12	1,190	5	OG-ST-SMF-D	81120041821
D-MH	60x245x10	195	14X26	42x125,6	4	150	M12	2,200	5	OG-ST-SMH-D	81120041241

HOT-DIP GALVANIZED ELEMENTS

OG-ST CHANNEL CONNECTOR OG-LSE

## CHANNEL CONNECTOR OG-LSE



hot-dip galvanized

**Usage:** for creating facial structural connections of channels; it allows for multiple adjustment of the fixing opening location in the channel; it makes professional connection of flat and spatial fixing systems easier.

### Set includes:

- connector,
- a threaded plate,
- four round washers,
- four bolts with hexagonal heads, full thread.

Permissible load



For channels	Dimensions					Weight [kg]	Designation for the order	Catalogue number
	A [mm]	L [mm]	H [mm]	g [mm]	M [mm]			
MF, MH, MI	42	226	40	4	M12	0,810	OG-LSE-MF	81140141411