

for multi-wire Cu cables

MS Receptacle

Material: brass
According to DIN 46247

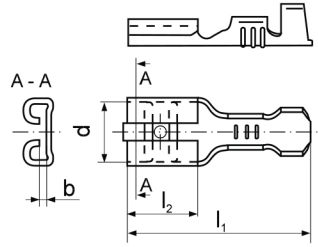

Nominal wire cross section [mm ²]	Cross section [mm ²]	Symbol	b [mm]	l ₁ [mm]	l ₂ [mm]	d [mm]	Cable insulation diameter	Weight [g/pce]	Unit [pcs]	Crimping tools
1	> 0,5 ÷ 1	MS 2,8-1	0,4	14	6,3	3,1	2 ÷ 3,3	0,23	100	PR33, S33-1,
1	> 0,5 ÷ 1	MS 2,8-1A	0,8	14	6,3	3,1	2 ÷ 3,3	0,22	100	S55
1	> 0,5 ÷ 1	MS 6,3-1	0,8	19,2	7,5	6,7	2 ÷ 3,3	0,68	100	PR33, S11-6,
2,5	> 1,0 ÷ 2,5	MS 4,8-2	0,8	15,6	6,3	5,1	2,7 ÷ 4,3	0,57	100	S55,
2,5	> 1,0 ÷ 2,5	MS 6,3-2	0,8	19,2	7,5	6,7	2,7 ÷ 4,3	0,72	100	PP8, PP19
6	> 2,5 ÷ 6	MS 6,3-6	0,8	19,2	7,5	6,7	3,8 ÷ 5,1	0,86	100	

Standard production – non tinned. When ordering tinned add 'Sn' symbol e.g. MS 6,3-2 Sn. When ordering nickel plated add 'Ni' symbol e.g. MS 6,3-6 Ni. Made on request.

for multi-wire Cu cables

TS Tab

Material: brass
According to DIN 46248

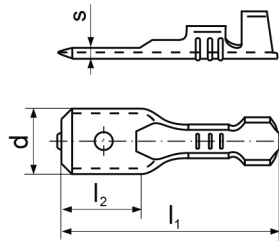

Nominal wire cross section [mm ²]	Cross section [mm ²]	Symbol	s [mm]	l ₁ [mm]	l ₂ [mm]	d [mm]	Cable insulation diameter	Weight [g/pce]	Unit [pcs]	Crimping tools
1	> 0,5 ÷ 1	TS 6,3-1	0,8	20	8,5	6,3	2 ÷ 3,3	0,59	100	
2,5	> 1 ÷ 2,5	TS 4,8-2*	0,8	17	7,2	4,8	2,7 ÷ 4,3	0,50	100	PR33, S11-6,
2,5	> 1 ÷ 2,5	TS 6,3-2	0,8	20	8,5	6,3	2,7 ÷ 4,3	0,67	100	S55,
6	> 2,5 ÷ 6	TS 6,3-6	0,8	20	8,5	6,3	3,8 ÷ 5,1	0,76	100	PP8, PP19

Standard production – non tinned. When ordering tinned add 'Sn' symbol e.g. TS 6,3-2 Sn. When ordering nickel plated add 'Ni' symbol e.g. TS 6,3-6 Ni. Made on request.

for multi-wire Cu cables

MK Angle terminal

Material: brass
According to DIN 46346 - part B

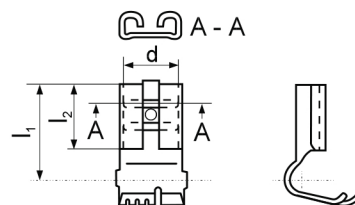

Cross section [mm ²]	Symbol	l ₁ [mm]	l ₂ [mm]	d [mm]	Cable insulation diameter	Weight [g/pce]	Unit [pcs]	Crimping tools
0,75 ÷ 1	MK 6,3-2	11	7,5	6,7	2 ÷ 3,3	0,69	100	SK1, PP8, PP19
1,5 ÷ 2,5 *	MK 6,3-2	11	7,5	6,7	2,7 ÷ 4,3	0,72	100	SK2N, PP8, PP19

* – outside DIN standard.

Standard production – non tinned. When ordering tinned add 'Sn' symbol e.g. MK 6,3-2 Sn.