

# SubConn® Micro Circular

## 10, 12 and 16 contacts

### Connector specifications

Voltage rating	300 V DC/AC rms
Current rating	5 A per contact (max 30 A per connector)
Insulation resistance	> 200 Mohm
Contact resistance	< 0,01 ohm
Wet matings	> 500 (open face rated)
Temperature rating (water)	- 4 to 60°C, 25 to 140°F
Temperature rating (air)	- 40 to 60°C, - 40 to 140°F
Storage temperature rating	- 40 to 60°C, - 40 to 140°F
Qualified pressure tested	800 bar, 11,600 psi
Depth rating PEEK	300 bar, 4,350 psi

### Material specifications

Connector body	Chloroprene rubber
Bulkhead body	Brass, stainless steel, titanium, anodised aluminium or PEEK
Contacts	Female sockets in gold plated brass UNS - C36000 Male pins in gold plated beryllium copper
O-rings	Nitrile
Locking sleeves	POM or stainless steel
Snap rings	Stainless steel AISI 302
Inline cable (2 ft, 60 cm)	20 AWG, 0.52 mm <sup>2</sup> chloroprene rubber
Bulkhead and PBOF leads (1 ft, 30 cm)	20 AWG, 0.52 mm <sup>2</sup> coloured PTFE
OM leads (3", 7 cm)	20 AWG, 0.52 mm <sup>2</sup> coloured PTFE

### Face view (male)



### Inline cable colour code

1 Black	5 Orange	9 Green/black	13 Red/white
2 White	6 Blue	10 Orange/black	14 Green/white
3 Red	7 White/black	11 Blue/black	15 Blue/white
4 Green	8 Red/black	12 Black/white	16 Black/red

### Nominal cable outside diameter (OD)

10 conductor cable	0.406", 10.3 mm
12 conductor cable	0.436", 11.0 mm
16 conductor cable	0.472", 12.0 mm

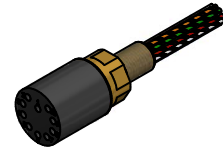
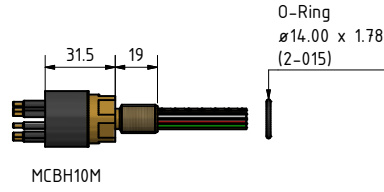
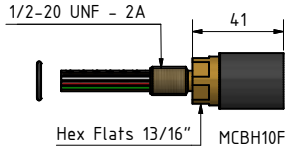
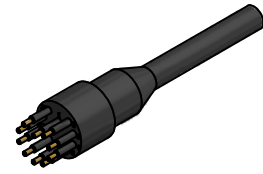
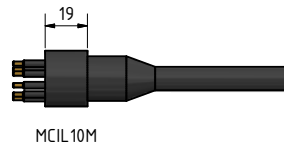
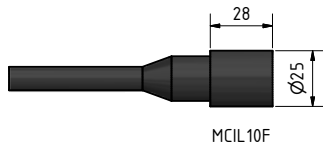

Note:  
RA Body are  
not available in  
Ti, AS & PEEK matr.

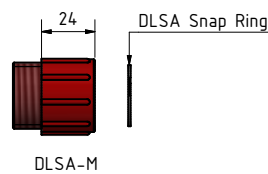
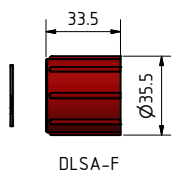
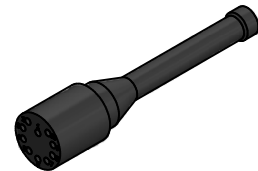
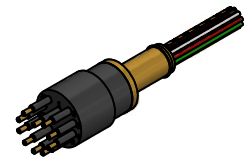
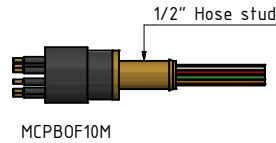
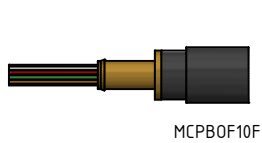
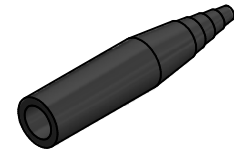
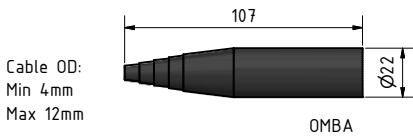
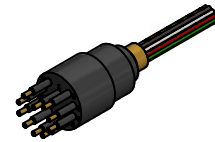
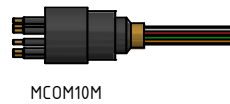
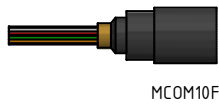
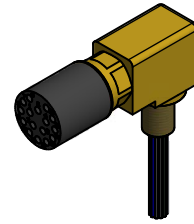
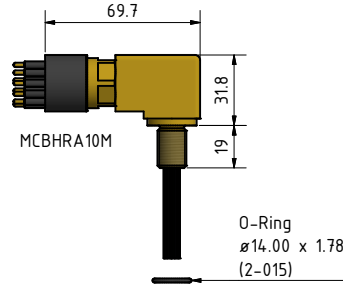
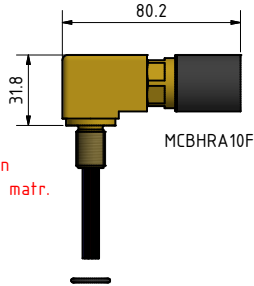

**Drawing information**

Dimensions in mm (1 mm = 0.03937 inch)  
Threads in inches (1 inch = 25.4 mm)

