

DATASHEET - SB 150 - 1 Ex SOUNDER & BEACON

AUDIBLE & VISUAL SIGNALLING EQUIPMENT



DESCRIPTION SB 150 series Ex Sounder & Beacon is designed according to EN 60079-0, EN 60079-1 and EN 54 (BS 5879) standard. Enclosure material is UV and corrosion resistance GRP (Glass Reinforced Polyester). Ex-tech also recommends anti static GRP material for your consideration. This product is certified for use and installation in Zone 1 and Zone 2 areas with gases groups of IIA, IIB, IIC and temperature classification of T4~T6. It specially applies to Oil & Gas, Offshore Platform, Chemical, Petrochemical, Refinery and Marine Industries etc.

SB 150-I single unit Sounder& Beacon has features of both BC 150 and SD 150-I. Different flash or rotary rate can be adjusted from unique design. Three working statuses-flash type, rotary type and steady type are available (LED).

According to user control system, 4 stages of alarm tones can be sent out, from less critical stage (stage 1) to the most critical stage (stage 4). 63 tones are selectable. Tone can be preset during installation. At the same time, four stages of alarm light can also be sent out. Twin xenon tube type is also available for option. SB 150-I can also be customized to be telephone initiated to company with Ex-telephone in comunion system.

MAIN FEATURES • Ex d IIC T4~T6 • ZONE 1 & 2 USE • IP 66/67 • UV and corrosion resistance GRP housing material • Natural colour w/o painting • Xenon or LED available • Flash or rotary type • Flash or rotary rate adjustable • 4 Stages of alarm light output • 4 different colours flashing in sequence (LED) • 4 stages of alarm tones output • 63 tones selectable • Every stage tone can be chosen freely • Sound recording or customization • Build-in volume control • Bracket mounting type • Telephone initiated type optional • Twin Xenon tube type optional •

INTENDED USE



- zone 1 & 2
- zone 21 & 22 (pending)

ORDER INFORMATION - SB 150 - 1 - EX SOUNDER AND BEACON

PRODUCT NUMBER	LENS COLOUR	BEACON TYPE	POWER	VOLTAGE	DUTY LABEL	TAG LABEL*	LENS GUARD*	CABEL ENTRY	FINISH COLOUR	TELEPHONE INITIATED
SB 150 - 1	<input checked="" type="checkbox"/> R = RED <input type="checkbox"/> Y = YELLOW <input type="checkbox"/> B = BLUE <input type="checkbox"/> G = GREEN <input type="checkbox"/> C = CLEAR	X = XENON L = LED	02 Xenon: 2J 05 LED: 5W Xenon: 5J 10 LED: 10W Xenon: 10J 15 Xenon: 15J 20 Xenon: 20J	DC 12 ~ 48V AC 100 ~ 240V OR OTHER Other voltages available on request.	Y = YES (specify)	Y = YES (specify)	Y = YES	A - M20 B - M25 C - ½" NPT D - ¾" NPT O - OTHER	<input checked="" type="checkbox"/> RD = RED <input type="checkbox"/> BU = BLUE <input type="checkbox"/> OR = OTHER	Y = YES N = NO

MODEL CONFIGURATOR

SB 150 - 1 + [] [] [] [] [] [] [] [] [] []

* These accessories need to be ordered separately. Please refer to your local Ex-tech sales office for further information

DIMENSIONS - SB 150 - 1 - EX SOUNDER AND BEACON

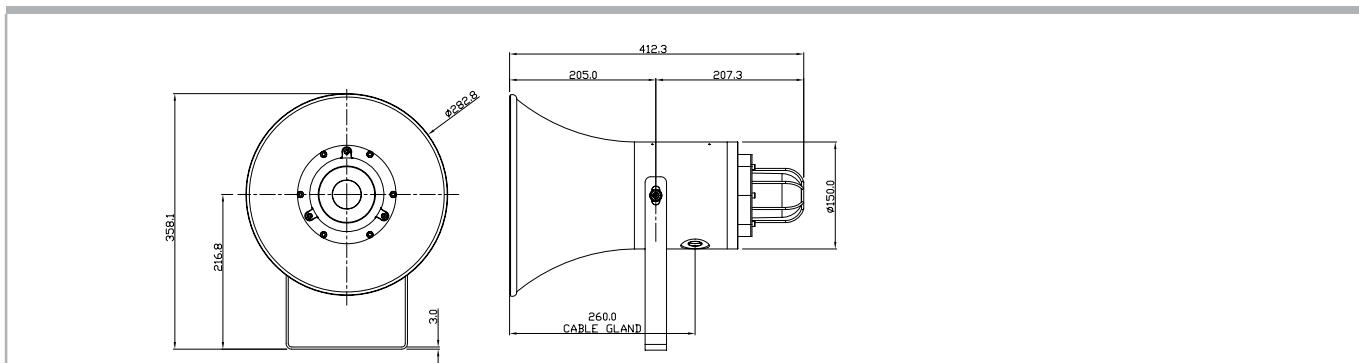

21.01.13 | REV. 02 | PAGE 1/2

DATASHEET - SB 150 - 1 Ex SOUNDER & BEACON

AUDIBLE & VISUAL SIGNALLING EQUIPMENT

SPAREPARTS & ACCESSORIES

Tag Label (Specified)	50070210229	* M20 x 1.5 Blind Plug	55100110920	M20 EX SS Blind Plug	55100110920
Telephone Initiated PCB	50110105201	* M25 x 1.5 Blind Plug	55100110925		
Twin Xenon Tube Type	50060105201	* 1/2" NPT Blind Plug	55100110821		
Lens Guard	50060110109	* 3/4" NPT Blind Plug	55100110843		

* Ex Stainless Steel Blind Plug (Selectable or Specify)

TECHNICAL INFORMATION - SB 150 - 1 - Ex SOUNDER AND BEACON

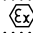
EX CODE	• Ex d IIC T4~T6
ATEX MARKING	• 
TONE SELECTION	• 63 tones selectable
SOUND OUTPUT	• Up to 115 dB
BEACON TYPE SELECTION	• Xenon or LED
TUBE ENERGY FOR XENON	• 2, 5, 10, 15, 21 Joule for Selection
LED OUTPUT	• Yellow Lens Cover-112 Candela; Red Lens Cover-94 Candela • Green Lens Cover-78 Candela; Blue Lens Cover-60 Candela
STATUS TYPE	• Flash; Rotary (LED only); Steady (LED only)
FLASH RATE	• 60/75/120 times/min (Flash once a time) • 100/120/150 times/min (Flash twice a time) • 120/150/180 times/min (Flash three times a time)
ROTARY RATE	• Rotary Rate is the same as Flash Rate. Rotary Type can be specially designed to provide LED in four different colours flashing in sequence.
AMBIENT TEMPERATURE	• -40 to + 70° C
HUMIDITY	• Up to 95% RH
MECHANICAL SPECIFICATION:	
MATERIAL	• Enclosure: UV and Corrosion Resistance GRP (Anti Static GRP Optional) • Mounting Bracket Material: Stainless Steel
LENS GUARD (OPTIONAL) MATERIAL	• Stainless Steel
LENS COVER MATERIAL	• Tempered Glass
LENS	• Red, yellow (amber), blue, green or clear
ENCLOSURE FINISH	• Red, blue or other (specify)
INGRESS PROTECTION	• IP 66/67
WEIGHT	• 6.5 kg
DIMENSIONS	• L - 412xdia. 281(mm) w/o Lens Guard
ELECTRICAL SPECIFICATION:	
POWER SUPPLY	• 12-48V DC/AC or 100-240V AC
POWER CONSUMPTION	• Sounder: 5-20W • Xenon: 2 Joule: 4W (Max); 5 Joule: 10W (Max); 10 Joule: 15W (Max); 15 Joule: 20W(Max); 21 Joule: 25W(Max) • LED: 5 W
WORKING CURRENTY	• Sounder: 250mA-1500mA • Xenon: 2 Joule: 160mA (Max); 5 Joule: 320mA (Max); 10Joule: 650mA (Max); 15 Joule: 1A (Max); 21Joule: 1.4A (Max) • LED: 220mA (Max)
TERMINAL	• Accept up to 2.5mm ² Cable
CABLE ENTRY	• 2xM20, M25, 1/2" NPT, 3/4"NPT or Others (Selectable)
CERTIFICATION	• ATEX, IECEx(Pending), IMETRO (Pending)

INTENDED USE



- zone I & 2
- zone 21 & 22 (pending)